

Transient Voltage Suppressors for ESD Protection

Features

- Low Clamping Voltage
- Working voltage:4.5V
- Low Leakage
- 3600 Watts peak pulse power (tp=8/20us)

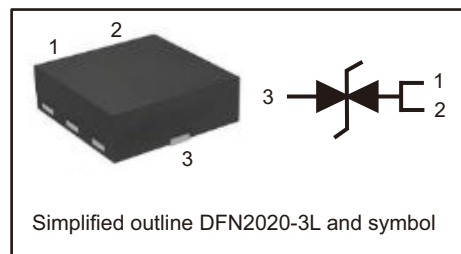

End Equipment

- Power lines
- Personal digital assistants (PDA's)
- Microprocessors based equipment
- Notebooks, Desktops, and Servers
- Cell phone Handsets and Accessories
- Portable Electronics
- Peripheral

Electronics Parameter

Parameter	Symbol
Maximum Reverse Peak Pulse Current	I_{PP}
Clamping Voltage @ I_{PP}	V_C
Peak Reverse Working Voltage	V_{RWM}
Reverse Leakage Current @ V_{RWM}	I_R
Breakdown Voltage @ I_T	V_{BR}
Test Current	I_T

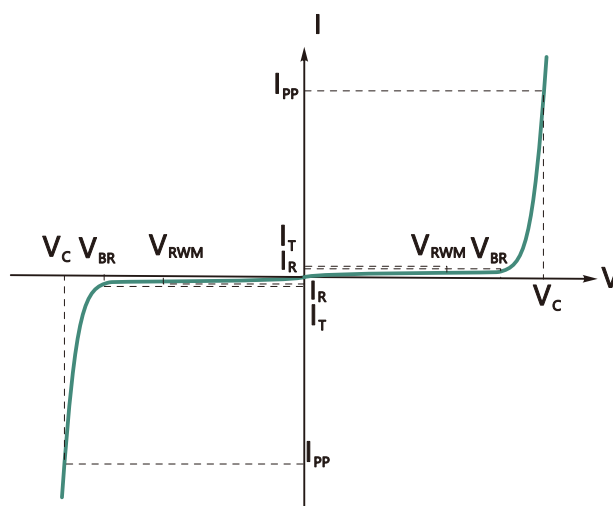



Absolute Maximum Ratings And Characteristics (Ta = 25 °C)

Parameter	Symbol	Value	Unit
Peak Pulse Power (8/20uS)	P _{pk}	3600	W
Peak Pulse Current	I _{pp}	300	A
ESD per IEC 61000-4-2 (Air) ESD per IEC 61000-4-2 (Contact)	V _{ESD}	±30 ±30	KV
Operating Temperature Range	T _J	-40 to +125	°C
Storage Temperature Range	T _{stg}	-55 to +150	°C

Characteristics at Ta = 25°C

Parameter	Symbol	Conditions	Minimum	Typical	Maximum	Units
Reverse stand-off Voltage	V _{RWM}				4.5	V
Breakdown Voltage	V _{BR}	I _T =1mA	4.8		6.0	V
Reverse Leakage Current	I _R	V _R =4.5V, Ta=25°C		10	100	nA
Clamping Voltage	V _C	I _{pp} =100A, t _p =8/20us		7	8	V
		I _{pp} =300A, t _p =8/20us		10	12	V
Junction Capacitance	C _j	V _R =0V, f=1MHz		300	400	pF



Typical Characteristics

Fig.1 Pulse Waveform

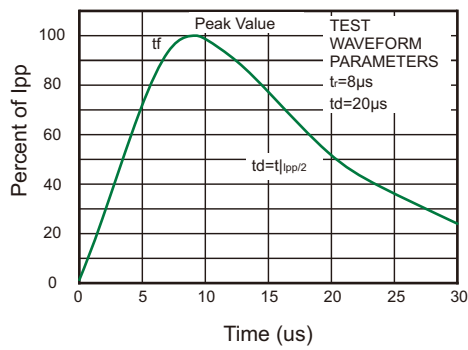

Fig.2 Contact discharge current waveform per IEC61000-4-2

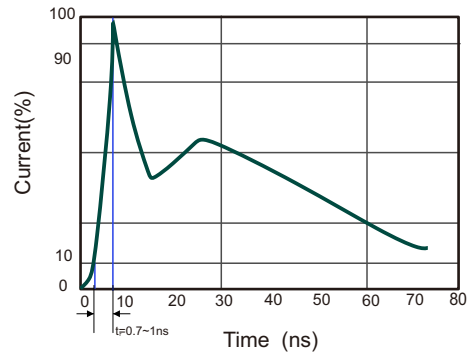
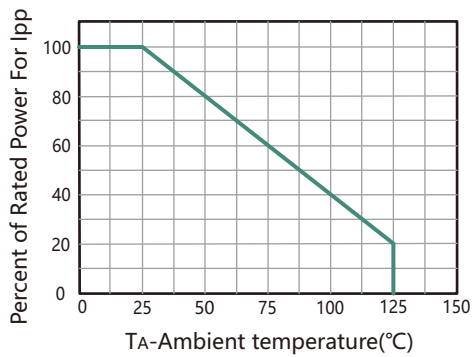
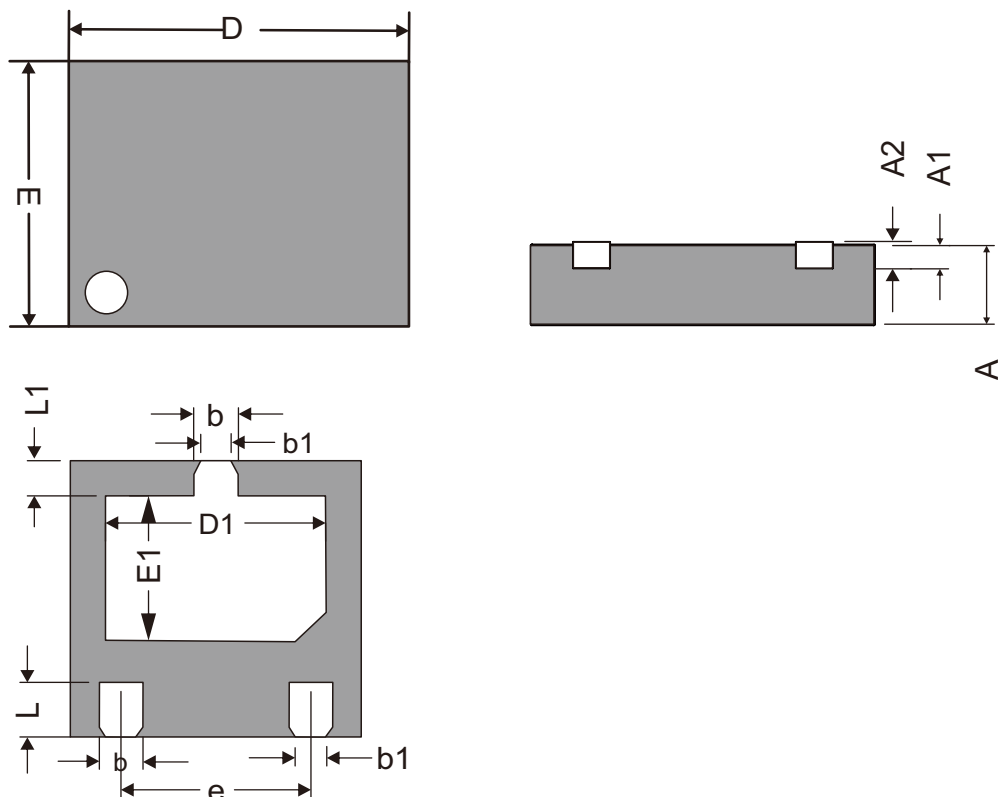

Fig.3 Power Derating Curve





DFN2020-3L Package Outline Dimensions



DFN2020-3L mechanical data

UNIT		A	A1	A2	b	b1	D	D1	E	E1	e	L	L1
mm	min	0.45	\	0.00	0.25	\	1.95	1.45	1.95	1.00	\	0.350	0.20
	typ	0.50	0.15	0.02	0.30	0.22	2.00	1.50	2.00	1.05	1.30	0.400	0.25
	max	0.55	\	0.05	0.35	\	2.05	1.55	2.05	1.10	\	0.450	0.30
mil	min	17.7	\	0.0	9.8	\	76.8	57.1	76.8	39.4	\	13.8	7.9
	typ	19.7	5.9	0.8	11.8	8.7	78.7	59.1	78.7	41.3	51.2	15.7	9.8
	max	21.7	\	2.0	13.8	\	80.7	61.0	80.7	43.3	\	17.7	11.8

The recommended mounting pad size

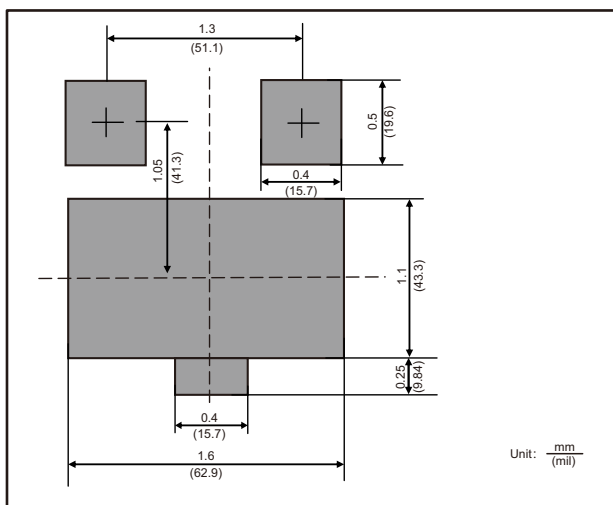

Marking

Type number	Marking code
ESDB4V5D23LPA	4.5H



Important Notice and Disclaimer

Jingdao Microelectronics reserves the right to make changes to this document and its products and specifications at any time without notice.

Customers should obtain and confirm the latest product information and specifications before final design, purchase or use.

Jingdao Microelectronics makes no warranty, representation or guarantee regarding the suitability of its products for any particular purpose, not does Jingdao Microelectronics assume any liability for application assistance or customer product design.

Jingdao Microelectronics does not warrant or accept any liability with products which are purchased or used for any unintended or unauthorized application.

No license is granted by implication or otherwise under any intellectual property rights of Jingdao Microelectronics.

Jingdao Microelectronics products are not authorized for use as critical components in life support devices or systems without express written approval of Jingdao Microelectronics.